

# DROP WIRE CLAMP HYPOCLAMP

## DESCRIPTION

The HYPOCLAMP drop clamps are installed on poles and walls to terminate fiber optic flat drop cables (spans up to 70m).

The HYPOCLAMP is composed of a metallic body, a metallic shim and plastic wedge with an integrant opening bail. The parts are delivered in kits for easiness of installation on the cable.

REF	MODEL	MATERIAL	Ø CABLE		PACK <sup>G</sup>
5129	HYPOCLAMP	Thermoplastic and stainless steel	10 x 4mm	0,04 kg	100

## TESTING

This clamp has been qualified in accordance with internationally recognised standards :

- Climatic ageing test according to NF EN C-20-540 standard dated June 2002.
- Corrosion test according to NF EN 60068-2-52 dated December 1996.
- Tensile test according to the technical specification ORANGE CCF/BI/BUBL of 20 May 2010.
- Vibration test according to the technical specification ORANGE CCF/BI/BUBL of 20 May 2010 and the standard NF EN 50289-3-13 d'août 2003 with insertion loss < 0.2 dB.

## INSTALLATION

- Tension the cable to the required installation load.
- Hang the clamp wedge onto the pole and wall hardware fitting and lock the bail.
- Place the clamp body round the cable.
- Position the shim onto the cable in the clamp body, with the gripping bumps facing the cable.
- Pass the wedge in the large section of the clamp body the initiate the clamping onto the shim + cable.

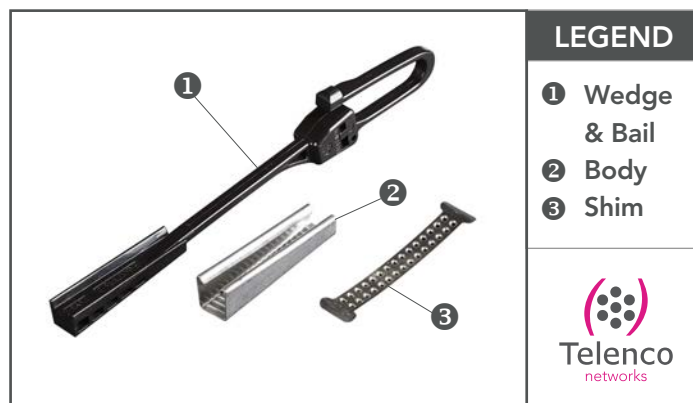

## FEATURES

- Easy and quick installation – no tools required.
- Efficient gripping on most flat FO drops due to the materials used.
- Installation without bending of the cable in the clamp.
- Opened bail for installation in closed or opened hardware : cross-arms, hooks, brackets (min Ø 11mm).

